

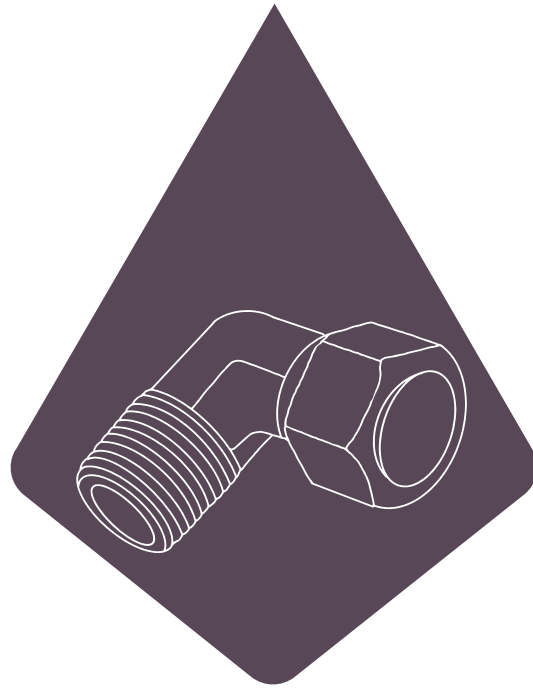

COMPRESSION
FITTINGS

COMPRESSION FITTINGS

INDUSTRIAL COMPRESSION
FITTINGS



INDUSTRIAL COMPRESSION FITTINGS



Compression Fittings provide users with an economical choice with numerous connection options for a wide variety of tube materials without the need for flaring, soldering or other tube preparation necessary to assemble.

Product Features:

- Meets functional requirements of SAEJ-512
- Brass or Acetal sleeve available
- No tube preparation
- Forged and Extruded shapes

Applications:

- Airlines
- Lubrication lines
- Cooling lines
- Industry
- Machinery
- Compressors
- Fluid transfer

Markets:

- Industrial
- Packaging
- Pneumatic
- Printing

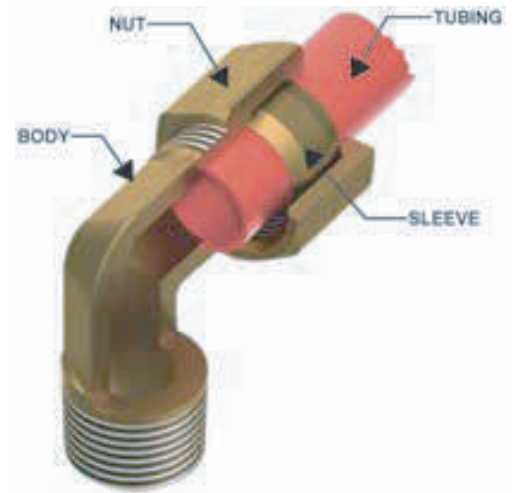

Assembly Instructions-

1. Slide nut then sleeve onto tubing. The thread end of the nut must face out.
2. Insert tube and bottom on the fitting shoulder
3. Assemble nut to body and tighten "hand tight". Then wrench tighten the number of turns indicated in the table

Compatible Tubing:

- Copper
- Aluminium
- Thermoplastic Tubing

Specifications:

Temperature Range: 0.65° to +200° F (-53.8° to +93.3° C)

Pressure Range

TUBE SIZE	PSI	bar	TUBE SIZE	PSI
1/8	2800	193.0	1/2	750
3/16	1900	131.0	5/8	650
1/4	1400	96.5	3/4	550
5/16	1200	82.7	7/8	450
3/8	1000	68.9		

Note: Pressures listed in above table are with brass



INDUSTRIAL COMPRESSION FITTINGS



Sleeve 60C REF. SAE 060115

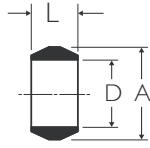

PART NO.	TUBE SIZE	A	D	L
AI 60C-2	1/8	.187	.130	.19
AI 60C-3	3/16	.266	.192	.22
AI 60C-4	1/4	.344	.255	.25
AI 60C-5	5/16	.406	.318	.25
AI 60C-6	3/8	.469	.382	.25
AI 60C-7	7/16	.531	.444	.31
AI 60C-8	1/2	.594	.507	.38
AI 60C-10	5/8	.719	.632	.38
AI 60C-12	3/4	.875	.758	.44
AI 60C-14	7/8	1.000	.883	.41

Long Nut 61CL REF. SAE 060111

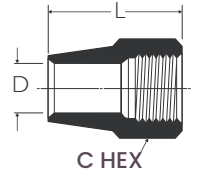

PART NO.	TUBE SIZE	STRAIGHT THREAD	C HEX	D	L
AI 61CL-4	1/4	7/16-24	1/2	.255	.75
AI 61CL-5	5/16	1/2-24	9/16	.318	.84
AI 61CL-6	3/8	9/16-24	5/8	.382	.97
AI 61CL-8	1/2	11/16-20	13/16	.507	1.06
AI 61CL-10	5/8	13/16-18	15/16	.632	1.19
AI 61CL-12	3/4	1-18	1-3/16	.758	1.38

Acetal Sleeve 60PT

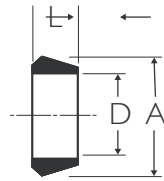

PART NO.	PLASTIC TUBE WALL	TUBE WALL	A	D	L
AI 60PT-4	1/4	.040	.375	.254	.19
AI 60PT-5	5/16	.062	.438	.317	.19
AI 60PT-6	3/8	.062	.500	.379	.19
AI 60PT-8	1/2	.062	.631	.507	.25
AI 60PT-10	5/8	.062	.747	.632	.22

Union 62C REF. SAE 060101 BA

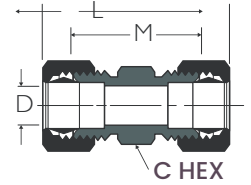

PART NO.	TUBE SIZE	STRAIGHT THREAD	C HEX	L	M	FLOW DIA. D
AI 62C-2	1/8	5/16-24	5/16	1.05	.64	.094
AI 62C-3	3/16	3/8-24	3/8	1.21	.72	.125
AI 62C-4	1/4	7/16-24	7/16	1.33	.79	.188
AI 62C-5	5/16	1/2-24	1/2	1.39	.85	.250
AI 62C-6	3/8	9/16-24	9/16	1.52	.97	.312
AI 62C-7	7/16	5/8-24	5/8	1.70	1.02	.312
AI 62C-8	1/2	11/16-20	11/16	1.90	1.08	.406
AI 62C-10	5/8	13/16-18	13/16	2.06	1.23	.500
AI 62C-12	3/4	1-18	1	2.37	1.41	.562
AI 62C-14	7/8	1-1/8-18	1-1/8	2.07	1.19	.766

Nut 61C REF. SAE 060110

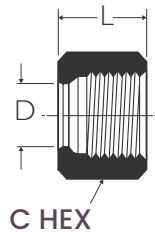

PART NO.	TUBE SIZE	STRAIGHT THREAD	C HEX	D	L
AI 61C-2	1/8	5/16-24	3/8	.130	.38
AI 61C-3	3/16	3/8-24	7/16	.192	.41
AI 61C-4	1/4	7/16-24	1/2	.255	.44
AI 61C-5	5/16	1/2-24	9/16	.318	.44
AI 61C-6	3/8	9/16-24	5/8	.382	.47
AI 61C-7	7/16	5/8-24	11/16	.444	.50
AI 61C-8	1/2	11/16-20	13/16	.507	.62
AI 61C-10	5/8	13/16-18	15/16	.632	.62
AI 61C-12	3/4	1-18	1-3/16	.758	.69
AI 61C-14	7/8	1-1/8-18	1-1/4	.890	.62

Union Reducers 62C REF. SAE 060101 BA

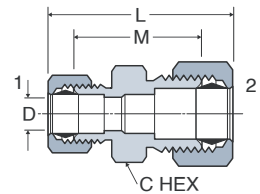

PART NO.	1 TUBE SIZE	2 TUBE SIZE	1 THREAD	2 THREAD	C HEX	L	M	FLOW DIA. D
AI 62C-4-3	3/16	1/4	3/8-24	7/16-24	7/16	1.29	.78	.125
AI 62C-6-4	1/4	3/8	7/16-24	9/16-24	9/16	1.46	.91	.188
AI 62C-8-6	3/8	1/2	9/16-24	11/16-20	11/16	1.71	1.03	.312
AI 62C-10-6	3/8	5/8	9/16-24	13/16-18	13/16	1.82	1.13	.312



INDUSTRIAL COMPRESSION FITTINGS

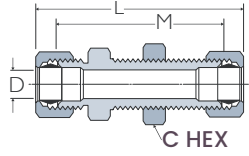

Bulkhead Union 62CBH

PART NO.	TUBE SIZE	STRAIGHT THREAD	C HEX	L	M	BULKHEAD HOLE DIA.	FLOW DIA. D
AI 62CBH-4	1/4	7/16-24	9/16	2.29	1.75	7/16	.188
AI 62CBH-6	3/8	9/16-24	11/16	2.42	1.88	9/16	.312

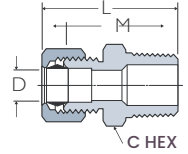

Male Connector 68C REF.SAE 060102 BA

PART NO.	TUBE SIZE	PIPE THREAD	STRAIGHT THREAD	C HEX	L	M	FLOW DIA. D
AI 68C-2-1	1/8	1/16	5/16-24	3/8	.99	.78	.095
AI 68C-2-2	1/8	1/8	5/16-24	7/16	.97	.77	.094
AI 68C-3-1	3/16	1/16	3/8-24	3/8	1.08	.84	.125
AI 68C-3-2	3/16	1/8	3/8-24	7/16	1.08	.84	.125
AI 68C-3-4	3/16	1/4	3/8-24	9/16	1.27	1.03	.125
AI 68C-4-2	1/4	1/8	7/16-24	7/16	1.10	.86	.188
AI 68C-4-4	1/4	1/4	7/16-24	9/16	1.30	1.06	.188
AI 68C-4-6	1/4	3/8	7/16-24	11/16	1.27	1.03	.188
AI 68C-4-8	1/4	1/2	7/16-24	7/8	1.55	1.31	.188
AI 68C-5-2	5/16	1/8	1/2-24	1/2	1.15	.89	.234
AI 68C-5-4	5/16	1/4	1/2-24	9/16	1.33	1.07	.250
AI 68C-6-2	3/8	1/8	9/16-24	9/16	1.25	.97	.250
AI 68C-6-4	3/8	1/4	9/16-24	9/16	1.42	1.14	.312
AI 68C-6-6	3/8	3/8	9/16-24	11/16	1.44	1.16	.312
AI 68C-6-8	3/8	1/2	9/16-24	7/8	1.53	1.25	.312
AI 68C-7-4	7/16	1/4	5/8-24	5/8	1.50	1.17	.312
AI 68C-8-4	1/2	1/4	11/16-20	11/16	1.60	1.20	.312
AI 68C-8-6	1/2	3/8	11/16-20	11/16	1.60	1.20	.406
AI 68C-8-8	1/2	1/2	11/16-20	7/8	1.71	1.31	.406
AI 68C-10-6	5/8	3/8	13/16-18	13/16	1.73	1.31	.406
AI 68C-10-8	5/8	1/2	13/16-18	7/8	1.90	1.48	.500
AI 68C-10-12	5/8	3/4	13/16-18	1-1/16	1.98	1.56	.500
AI 68C-12-8	3/4	1/2	1-18	1	2.05	1.60	.562
AI 68C-12-12	3/4	3/4	1-18	1-1/16	2.08	1.63	.656
AI 68C-14-12	7/8	3/4	1-1/8-18	1-1/8	1.76	1.41	.750

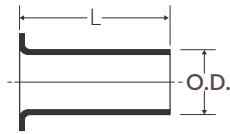

Brass Insert 63PT

PART NO.	TUBE O.D.	TUBE WALL	L	O.D.
AI 63PT-2-16	1/8	.016	.46	.080
AI 63PT-2-23	1/8	.023	.45	.073
AI 63PT-3-25	3/16	.025	.45	.135
AI 63PT-3-40	3/16	.040	.52	.095
AI 63PT-4-62	1/4	.062	.33	.110
AI 63PT-5-40	5/16	.040	.50	.232
AI 63PT-5-62	5/16	.062	.53	.187
AI 63PT-10-62	5/8	.062	.72	.483

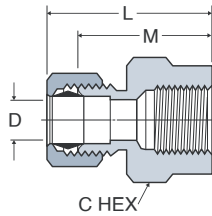

Female Connector 66C REF.SAE 060103 BA

PART NO.	TUBE SIZE	PIPE THREAD	STRAIGHT THREAD	C HEX	L	M	FLOW DIA. D
AI 66C-2-2	1/8	1/8	5/16-24	9/16	.95	.75	.094
AI 66C-3-2	3/16	1/8	3/8-24	9/16	1.02	.78	.125
AI 66C-3-4	3/16	1/4	3/8-24	11/16	1.20	.96	.125
AI 66C-4-2	1/4	1/8	7/16-24	9/16	1.02	.78	.188
AI 66C-4-4	1/4	1/4	7/16-24	11/16	1.24	1.00	.188
AI 66C-5-2	5/16	1/8	1/2-24	9/16	1.07	.81	.250
AI 66C-5-4	5/16	1/4	1/2-24	11/16	1.29	1.03	.250
AI 66C-6-2	3/8	1/8	9/16-24	9/16	1.06	.78	.312
AI 66C-6-4	3/8	1/4	9/16-24	11/16	1.34	1.06	.312
AI 66C-6-6	3/8	3/8	9/16-24	13/16	1.34	1.06	.312
AI 66C-6-8	3/8	1/2	9/16-24	1	1.54	1.27	.312
AI 66C-7-6	7/16	3/8	5/8-24	13/16	1.43	1.09	.312
AI 66C-8-4	1/2	1/4	11/16-20	11/16	1.49	1.09	.406
AI 66C-8-6	1/2	3/8	11/16-20	13/16	1.52	1.12	.406
AI 66C-8-8	1/2	1/2	11/16-20	1	1.71	1.31	.406
AI 66C-10-8	5/8	1/2	13/16-18	1	1.80	1.38	.500



INDUSTRIAL COMPRESSION FITTINGS

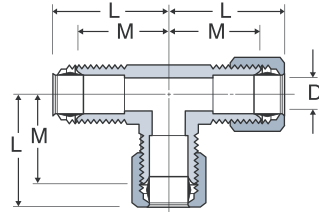

Union Tee 164C- 264C

REF. SAE 060401 BA

PART NO.	TUBE SIZE	STRAIGHT THREAD	L	M	FLOW DIA. D
Al 164C-2	1/8	5/16-24	.82	.61	.094
Al 264C-3	3/16	3/8-24	.84	.60	.125
Al 164C-4	1/4	7/16-24	.86	.63	.188
Al 264C-4	1/4	7/16-24	.84	.60	.188
Al 164C-5	5/16	1/2-24	.98	.71	.250
Al 164C-6	3/8	9/16-24	1.03	.74	.312
Al 164C-8	1/2	11/16-20	1.34	.93	.406
Al 164C-10	5/8	13/16-18	1.54	1.08	.500
Al 164C-12	3/4	1.00-18	1.65	1.17	.563

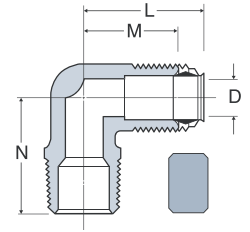

Male Elbow 169C- 269C

REF. SAE 060202 BA

PART NO.	TUBE SIZE	PIPE THREAD	STRAIGHT THREAD	L	M	N	FLOW DIA. D
Al 169C-2-1	1/8	1/16	5/16-24	.81	.60	.67	.095
Al 269C-2-2	1/8	1/8	5/16-24	.80	.60	.67	.094
Al 169C-3-1	3/16	1/16	3/8-24	.85	.61	.67	.126
Al 169C-3-2	3/16	1/8	3/8-24	.84	.61	.69	.125
Al 269C-3-2	3/16	1/8	3/8-24	.84	.60	.67	.125
Al 169C-3-4	3/16	1/4	3/8-24	.86	.64	.93	.125
Al 169C-4-2	1/4	1/8	7/16-24	.86	.61	.74	.188
Al 269C-4-2	1/4	1/8	7/16-24	.84	.60	.73	.188
Al 169C-4-4	1/4	1/4	7/16-24	.86	.62	.94	.188
Al 269C-4-4	1/4	1/4	7/16-24	.84	.60	.79	.188
Al 169C-4-6	1/4	3/8	7/16-24	.93	.68	1.00	.188
Al 169C-5-2 *	5/16	1/8	1/2-24	.88	.61	.74	.234
Al 269C-5-2 *	5/16	1/8	1/2-24	.86	.60	.73	.250
Al 169C-5-4	5/16	1/4	1/2-24	.95	.71	.93	.250
Al 269C-5-4	5/16	1/4	1/2-24	.93	.67	.82	.250
Al 169C-5-6	5/16	3/8	1/2-24	1.01	.75	1.00	.250
Al 169C-6-2 *	3/8	1/8	9/16-24	1.03	.74	.74	.234
Al 269C-6-2 *	3/8	1/8	9/16-24	.97	.69	.75	.220
Al 169C-6-4	3/8	1/4	9/16-24	1.03	.74	.93	.312
Al 269C-6-4	3/8	1/4	9/16-24	1.01	.73	.92	.312
Al 169C-6-6	3/8	3/8	9/16-24	1.03	.75	1.00	.312
Al 269C-6-6	3/8	3/8	9/16-24	1.12	.84	.97	.312
Al 169C-6-8	3/8	1/2	9/16-24	1.22	.94	1.27	.312
Al 269C-7-6	7/16	3/8	5/8-24	1.16	.82	.98	.312
Al 169C-8-4 *	1/2	1/4	11/16-20	1.34	.94	1.00	.312
Al 169C-8-6	1/2	3/8	11/16-20	1.34	.93	1.11	.406
Al 169C-8-8	1/2	1/2	11/16-20	1.48	1.00	1.37	.406
Al 169C-10-8	5/8	1/2	13/16-18	1.48	1.06	1.31	.500
Al 169C-12-8	3/4	1/2	1-18	1.64	1.18	1.49	.562
Al 169C-12-12	3/4	3/4	1-18	1.70	1.27	1.58	.562

Union Tee 164C- 264C Combination Sizes

REF. SAE 060401 BA

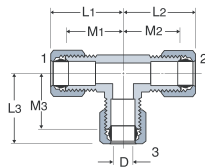

PART NO.	1 TUBE SIZE	2 TUBE SIZE	3 TUBE SIZE	L1	L2	L3	M1	M2	M3	FLOW DIA. D
Al 164C-6-4-4	3/8	1/4	1/4	1.03	.96	.96	.75	.72	.72	.188
Al 164C-6-6-4	3/8	3/8	1/4	1.03	.96	.96	.75	.75	.72	.188
Al 164C-8-8-6	1/2	1/2	3/8	1.34	1.16	1.16	.94	.94	.88	.312

Union Elbow 165C- 265C

REF. SAE 060201 BA

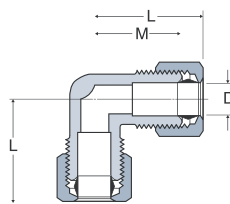

PART NO.	TUBE SIZE	STRAIGHT THREAD	L	M	FLOW DIA. D
Al 165C-2	1/8	5/16-24	.82	.61	.094
Al 165C-3	3/16	3/8-24	.87	.61	.125
Al 165C-4	1/4	7/16-24	.88	.61	.188
Al 265C-4	1/4	7/16-24	.84	.60	.188
Al 165C-5	5/16	1/2-24	.95	.71	.250
Al 165C-6	3/8	9/16-24	1.03	.74	.312
Al 165C-7	7/16	5/3-24	1.16	.82	.312
Al 165C-8	1/2	11/16-20	1.34	.93	.406
Al 165C-10	5/8	13/16-18	1.48	1.05	.500
Al 165C-12	3/4	1-18	1.65	1.17	.563

* For these parts the pipe thread through hole is smaller than the through hole on the flare end.



INDUSTRIAL COMPRESSION FITTINGS



Female Elbow 170C- 270C

REF. SAE 060203 BA

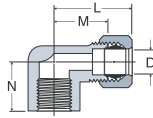

PART NO.	TUBE SIZE	PIPE THREAD	STRAIGHT THREAD	L	M	N	FLOW DIA. D
170C-2-2	1/8	1/8	5/16-24	.89	.69	.56	.094
170C-3-2	3/16	1/8	3/8-24	.98	.69	.56	.125
170C-4-2	1/4	1/8	7/16-24	.93	.69	.56	.188
270C-4-2	1/4	1/8	7/16-24	.91	.67	.54	.188
170C-4-4	1/4	1/4	7/16-24	1.02	.78	.67	.188
170C-6-4	3/8	1/4	9/16-24	1.06	.79	.73	.312
170C-6-6	3/8	3/8	9/16-24	1.22	.89	.69	.312
170C-7-4	7/16	1/4	5/8-24	1.27	.93	.73	.312
170C-8-6	1/2	3/8	11/16-20	1.34	1.00	.69	.406
170C-8-8	1/2	1/2	11/16-20	1.56	1.15	.97	.408
170C-12-12	3/4	3/4	1-18	2.06	1.58	1.58	.563

Adapter Tee 176C

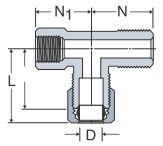

PART NO.	TUBE SIZE	PIPE THREAD	STRAIGHT THREAD	L	M	N	N1	FLOW DIA. D
176C-4-2	1/4	1/8	7/16-24	.93	.69	.75	.66	.188

Female Branch Tee 177C

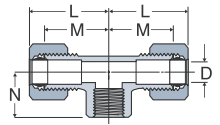

PART NO.	TUBE SIZE	PIPE THREAD	STRAIGHT THREAD	L	M	N	FLOW DIA. D
177C-4-2	1/4	1/8	7/16-24	.86	.63	.53	.188

Male Run Tee 171C

REF. SAE 060424 BA

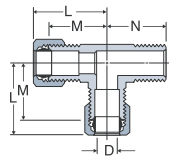

PART NO.	TUBE SIZE	PIPE THREAD	STRAIGHT THREAD	L	M	N	FLOW DIA. D
171C-2-2	1/8	1/8	5/16-24	.82	.61	.67	.094
171C-3-2	3/16	1/8	3/8-24	.86	.61	.67	.125
171C-4-2	1/4	1/8	7/16-24	.90	.64	.75	.188
171C-4-4	1/4	1/4	7/16-24	.93	.69	.92	.188
171C-6-4	3/8	1/4	9/16-24	1.09	.81	1.03	.312

45° Elbow 179C

Compression to male pipe

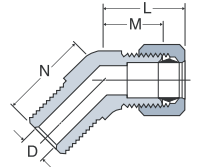

PART NO.	TUBE SIZE	PIPE THREAD	STRAIGHT THREAD	L	M	N	FLOW DIA. D
179C-4-2	1/4	1/8	7/16-24	.90	.66	.56	.188
179C-4-4	1/4	1/4	7/16-24	.80	.56	.84	.188
179C-6-2	3/8	1/8	9/16-24	.90	.63	.65	.234
179C-6-4	3/8	1/4	9/16-24	.90	.63	.84	.312
179C-6-6	3/8	3/8	9/16-24	.97	.75	.95	.312
179C-8-6	1/2	3/8	11/16-20	1.15	.81	.95	.406

Male Branch Tee 172C

REF. SAE 060425 BA

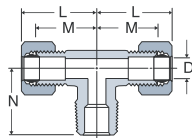

PART NO.	TUBE SIZE	PIPE THREAD	STRAIGHT THREAD	L	M	N	FLOW DIA. D
172C-2-2	1/8	1/8	5/16-24	.82	.61	.67	.094
172C-3-2	3/16	1/8	3/8-24	.86	.61	.67	.125
172C-4-2	1/4	1/8	7/16-24	.86	.61	.74	.188
172C-4-4	1/4	1/4	7/16-24	.93	.69	.92	.188
172C-6-2	3/8	1/8	9/16-24	1.03	.75	.75	.234
172C-6-4	3/8	1/4	9/16-24	1.09	.77	.92	.312
172C-6-6	3/8	3/8	9/16-24	1.09	.81	1.00	.312
172C-8-6	1/2	3/8	11/16-20	1.34	.93	1.10	.406

Seal Plug 639C

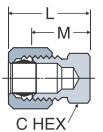

PART NO.	TUBE SIZE	STRAIGHT THREAD	C HEX	L	M
639C-4	1/4	7/16-24	7/16	.74	.50

Straight Through Tank Fitting 682C

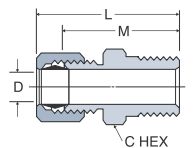

PART NO.	TUBE SIZE	PIPE THREAD	STRAIGHT THREAD	C HEX	L	M	FLOW DIA. D
682C-3-2	3/16	1/8	3/8-24	7/16	1.06	.84	.195
682C-6-6	3/8	3/8	9/16-24	11/16	1.44	1.16	.387
682C-8-8	1/2	1/2	11/16-20	7/8	1.90	1.31	.516





AQURA



307, Kalpataru Plaza, Chincholi
Bunder Road, Malad (W), Mumbai,
Maharashtra - 400064



ankit@axelongroup.com



Tel : +91 2886772050
to 2099

